

# SANITARY DRAINS

## FIG. 3811 SERIES, 3821 SERIES DRIP AND CONDENSATE FUNNELS

**FUNCTION:** Ideal for hospitals and industrial laboratories where indirect waste lines above the floor require receptors to receive drip, condensate or waste water. Use of "P" trap recommended for preventing sewer gases from entering room.

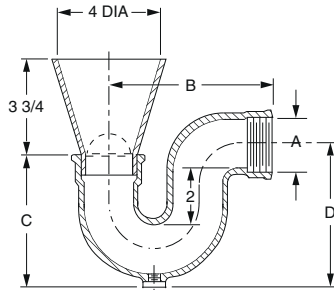
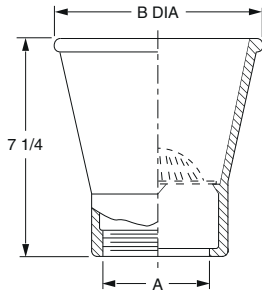
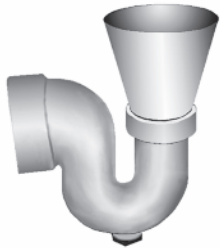

**OUTLET VARIATIONS** (Specify type of outlet and pipe size in inches.)

Outlet Type	Outlet Designation Outlet Type/Pipe Size	ADD
Threaded.....	T02, T03, T04, T05, T06 (3811 thru 3814 only)	98.00
No-Hub.....	Y02, Y03, Y04, Y05, Y06	See Fig. 2646Y

**OPTIONS:**

		ADD
-DBS	Aluminum Dome Bottom Strainer	117.00
-DBS	ARC CI DBS Figs 3811 or 3821	114.00
-DBS	Duco CI DBS Figs 3812 or 3822	87.00
-DBS	Cast Bronze DBS Figs 3813 or 3823	114.00
-DBS	Chrome Plated DBS Figs 3814 or 3824	210.00
-FC	Front Cleanout (Trap Series Only)	N/C
-NB	4" Dia NB Funnel w/Bronze Trap (Add to 3823)	59.00
-NB6	6" Dia NB Funnel w/Bronze Trap (Add to 3823)	264.00

FUNNEL ONLY - REGULARLY FURNISHED CAULK OUTLET					
FIG. NO	DESCRIPTION	A PIPE SIZE			
		02"	03"	04"	06"
3811	Cast Iron with ARC Interior & Exterior	689.00	752.00	1,065.00	1,095.00
3812	Duco Cast Iron	377.00	440.00	752.00	781.00
3813	Cast Bronze	895.00	937.00	1,989.00	2,676.00
3814	Polished Chrome Plated Cast Bronze	1,032.00	1,082.00	2,127.00	2,957.00
<b>B DIA</b>		6	7	8	10
<b>APPROX WT. LBS.</b>		6	8	10	10
FUNNEL WITH TRAP - THREADED OUTLET ONLY					
FIG. NO	DESCRIPTION	A PIPE SIZE			ADD FOR 6" DIA FUNNEL
		0150"	02"	03"	
3821	Cast Iron with ARC Interior & Exterior	691.00	1,010.00	1,167.00	108.00
3822	Duco Cast Iron	440.00	726.00	849.00	108.00
3823	Cast Bronze	1,298.00	1,298.00	2,115.00	202.00
3824	Polished Chrome Plated Cast Bronze	2,002.00	2,002.00	2,448.00	221.00
<b>B</b>		6	6	6	
<b>C</b>		5	5	6	
<b>D</b>		5 1/2	5 1/2	6	
<b>APPROX WT. LBS.</b>		9	9	13	2

**REGULARLY FURNISHED:** As described by Figure Number.

SANITARY DRAINS