

C



**JAY R. SMITH MFG. CO.**  
 MEMBER OF MORRIS GROUP INTERNATIONAL  
 POST OFFICE BOX 3237  
 MONTGOMERY, ALABAMA 36109-0237 (USA)  
 TEL: 334-277-8520 FAX: 334-272-7396 www.jrsmith.com



MEMBER OF:

LOCATION

# TRAP PRIMER FITTINGS

## AUXILIARY INLET FITTINGS

**FUNCTION:** Used as a means of inserting a trap primer connection in the outlet of a conventional floor drain. Fig. 2697 is available with a 2"(51) side tapping which can be used as an auxiliary inlet.

SPIGOT OUTLET

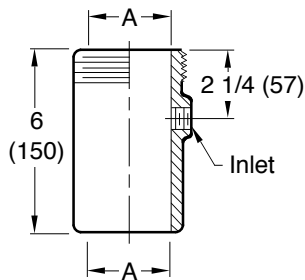

A (Pipe Size) = 02(50), 03(75) or 04(100)

THREADED OUTLET

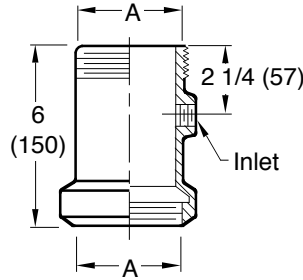

A (Pipe Size) = 02(50), 03(75) or 04(100)

CAULK OUTLET

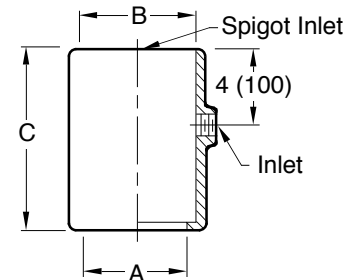

- Fig. 2695S (shown)
- Fig. 2695Y same as 2695S except spigot is sized for Service Weight and/or NO-HUB
- Fig. 2695Y-2 same as 2695S except both ends are sized for Service Weight and/or NO-HUB
- Fig. 2695Y-1 same as 2695Y-2 except inlet is not tapped for Trap Primer Connection

Fig. 2696T

Fig. 2697C

A SIZE	B SIZE	C
02(50)	3(76)	7 1/2(190)
03(75)	4(100)	7 1/2(190)
04(100)	4(100)	8 1/2(215)

**REGULARLY FURNISHED:**  
 Duco Cast Iron with 1/2"(13)  
 NPT Inlet Tapping.

**VARIATIONS:**

3/4"(19) NPT Inlet -P075

2"(51) NPT Inlet -N2  
 (Fig. 2697 03(75) & 04(100)  
 sizes only)

**OPTIONAL MATERIALS:**

Galvanized Cast Iron -G

**NOTE:** Dimensions shown in parentheses are in millimeters.

DRAWING NUMBER  
S2695SIZE  
ASCALE:  
NONEDATE:  
5-17-85APPROVED BY:  
TDCHECKED BY:  
TDDRAWN BY:  
PJFIGURE NUMBER  
2695,2696,2697WE CAN ASSUME NO RESPONSIBILITY FOR USE OF SUPERSEDED OR VOID DATA  
DIMENSIONS ARE SUBJECT TO MANUFACTURERS TOLERANCE AND CHANGE WITHOUT NOTICE

REV.	DATE	DESCRIPTION	BY	CKD. BY	WEIGHT POUNDS	VOLUME CUBIC FEET	FIGURE NUMBER
	C 6-15-17 B 10-17-95 A 11-23-93	Revised Table, Variations Added Millimeters Submittal Update	TBW EMB EMB	CL BS BS			<b>2695,2696,2697</b>



**WARNING:** Cancer and Reproductive Harm - www.P65Warnings.ca.gov