

#14

#3 Phillips drive, 10 tpi, drill point  
For insulation and membrane attachment to wood,  
steel, and structural concrete roof decks

- Available pre-assembled to plastic Dekflat plate for insulation attachment and to seam plates for roof cover attachment.
- 10 threads per inch for ease of installation in concrete roof decks.
- Low profile truss head can be used for clip attachment in applications where head height is important.

- Deep #3 recess provides for ultimate bit engagement.
- The Dekfast reduced drill point provides for ultimate pull-out values by producing a minimum opening. Thread engagement is superior as compared to standard drill points.



Application

#14 Dekfast Fasteners  
Insulation board to roof deck

Materials:

- Steel thickness from 22 ga (.028 in.) through 18 ga (.045 in.):  
Min penetration: 3/4"
- Plywood: Min thickness: 3/4"  
FR treated; min through penetration: 1/4"
- Wood 2x (1-1/2" thick):  
Min penetration: 1"
- Structural concrete:  
Min penetration: 1"

Use with:

- Dekfast 2-7/8" hex plates
- Dekfast 3" round plastic Dekflat plates
- Other attachment elements approved by the roofing system manufacturer for use with its products

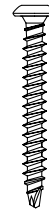
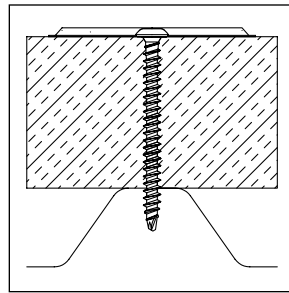

Head: #3 Phillips  
Head Height: .118" max  
Head Dia: .448" max  
Thread Major Dia: .238"  
Shank Dia: .180"

**Strength (lbs ult.):**  
Tensile: 3600  
Torsional: 110 in-lbs min  
Shear: 2630

**Pull-out: (lbs avg.):**  
22 ga: 540  
20 ga: 630  
18 ga: 900  
4000 psi concrete (1" penetration): 850  
3/4" plywood (through penetration): 590  
2x dimensional lumber (1" penetration): 605

Notes

Dimensions are nominal inches unless noted. Steel roof decks include all FM-approved 18-20-22 ga. FM-approved wood decks include 3/4" FR plywood and 2x dimensional lumber. Structural concrete to be predrilled with standard 3/16" carbide bit to minimum 1/2" deeper than fastener penetration.

Selection

Length	Part No.	Steel	Wood	Concrete	Carton Wt. (lbs)	Carton Qty.	Skid Qty.
1-1/4"	A7210-999B	Up to 1/2"	Up to 1/4"	Up to 1/4"	12	1,000	60,000
2"	A7216-999B	Up to 1-1/4"	Up to 1-1/4"	Up to 1"	15	1,000	60,000
3"	A7224-999B	Up to 2-1/4"	Up to 2"	Up to 2"	24	1,000	60,000
4"	A7232-999B	1-1/4" to 3-1/4"	1-1/4" to 3"	2" to 3"	30	1,000	60,000
5"	A7240-999B	1-1/4" to 4-1/4"	1-1/4" to 4"	3" to 4"	38	1,000	40,000
6"	A7248-999B	2-1/4" to 5-1/4"	2-1/4" to 5"	4" to 5"	47	1,000	40,000
7"	A7256-999B	3-1/4" to 6-1/4"	3-1/4" to 6"	5" to 6"	27	500	30,000
8"	A7264-999B	4-1/4" to 7-1/4"	4-1/4" to 7"	6" to 7"	31	500	30,000
9"	A7272-999B	5-1/4" to 8-1/4"	5-1/4" to 8"	7" to 8"	34	500	12,000
10"	A7280-999B	6-1/4" to 9-1/4"	6-1/4" to 9"	8" to 9"	37	500	12,000
11"	A7288-999B	7-1/4" to 10-1/4"	7-1/4" to 10"	9" to 10"	42	500	12,000
12"	A7296-999B	8-1/4" to 11-1/4"	8-1/4" to 11"	10" to 11"	44	500	12,000

Approvals

Dekfast fasteners are Factory Mutual approved for attachment of insulation board and/or roof cover to roof deck. Refer to FM Approval Guide and Supplements for current FM approved insulation fastening patterns. #14 fasteners exceed Factory Mutual corrosion-resistance Standard 4470.

Installation

Tools: 2000–2500 rpm screw guns and #3 hardened Phillips bit. For structural concrete, 3/16" carbide bit and 1500 rpm max screw guns, or hammerdrills in the hammer mode.

Options

