

R

DRAWING NUMBER  
S5560QT

SIZE  
A

SCALE:  
NONE

DATE:  
12-8-86

APPROVED BY:  
TD

CHECKED BY:  
VGD

DRAWN BY:  
WAS

5560QT, 5561QT

FIGURE NUMBER

DIMENSIONS ARE SUBJECT TO MANUFACTURERS TOLERANCE AND CHANGE WITHOUT NOTICE

# 1/4 TURN QUARTERHORSE NON-FREEZE WALL HYDRANT

## BRONZE BOX TYPE "TWIN-TEMP" FOR HOT AND COLD WATER

**FUNCTION:** Provides positive non-freeze protection where water is required at the outside of the building. Ideal for use in food handling areas, dairies and other places where both hot and cold water are desired. The recessed box conceals the hose connection and operating mechanisms. 1/4 turn of the key allows full flow to be obtained. The locking cover prevents unauthorized use.

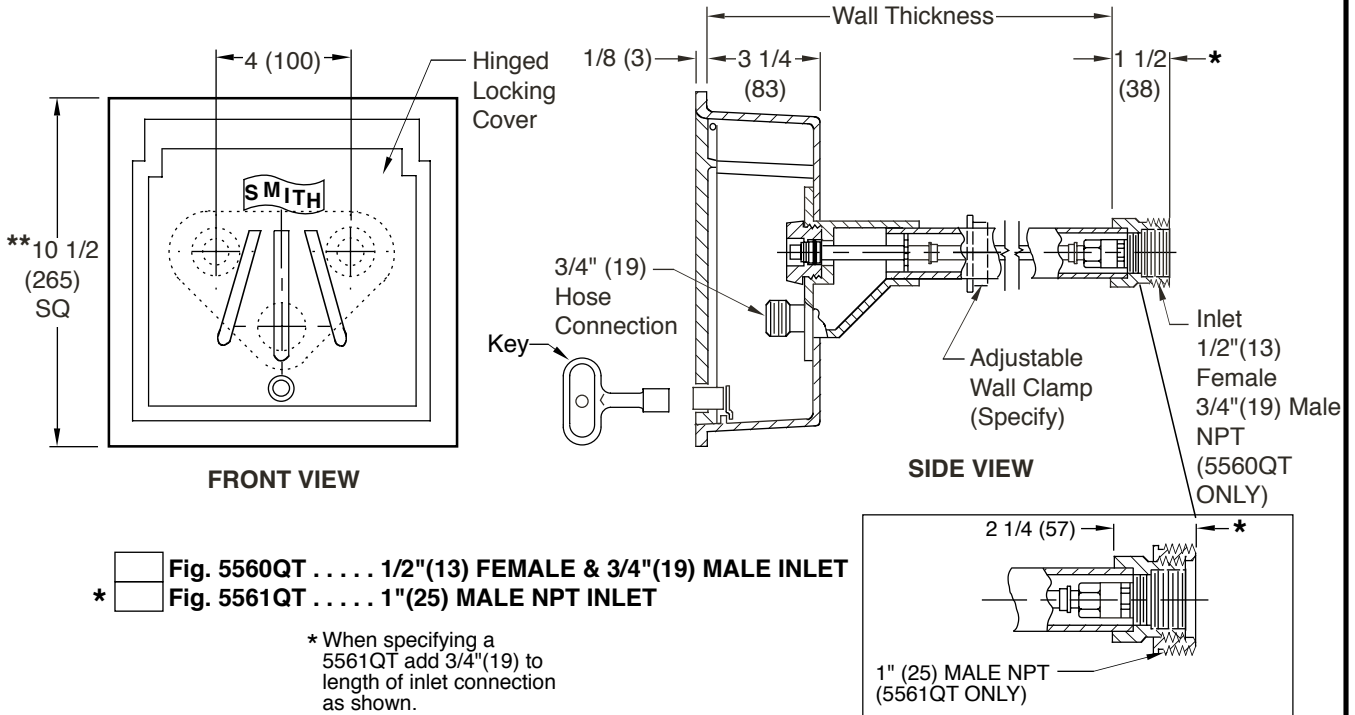

Fig. 5560QT . . . . 1/2"(13) FEMALE & 3/4"(19) MALE INLET  
 \*  Fig. 5561QT . . . . 1"(25) MALE NPT INLET

\* When specifying a 5561QT add 3/4"(19) to length of inlet connection as shown.

**REGULARLY FURNISHED:**

Bronze Quarter Turn Non-Freeze "Twin-Temp" Hydrant with Hose Connection, "T" Handle Key and Bronze Box with Chrome Plated Face. Inlet Size Furnished as Indicated by Figure Number Selected.

**VARIATIONS:**

- Adjustable Wall Clamp -WC
- Cylinder Lock -CL
- 1" (25) Hose Connection -HC1
- 3/4"(19) Vacuum Breaker (Self Draining Type) -H
- "Water" Cast On Cover -W
- Wheel Handle -WH

**OPTIONAL MATERIALS:**

- Nickel Bronze Box -NB
- Polished Bronze Hydrant -PB
- Rough Bronze Box -RB

**Installer is responsible for providing a 100% watertight positive seal at the hydrant to box interface and hydrant to wall interface. Seal all interior joints, seams, gasket seams/closures including around the hydrant box flange with an appropriate sealant recommended by a sealant manufacturer. NOTE: Jay R. Smith does not warrant the performance or life expectancy of the sealant material.**

- NOTES:**
1. Recommended Wall Opening 9 3/4"(250) x 9 3/4"(250). \*\*
  2. When ordering, specify wall thickness in 2"(51) increments as follows: 6(150), 8(205), 10(255), 12(305), 14(355), 16(405), 18(455), 20(510), 22(560) or 24(610). When wall clamp -WC is desired, increase wall thickness dimension by 2"(51).
  3. For 6"(150) wall use 5560QT-SAP or 5561QT-SAP.
  4. All Jay R. Smith hydrants are manufactured with "NO-LEAD" brazing rings and USDA approved lubricants.
  5. When optional vacuum breaker is supplied hose must be removed to allow draining to prevent freezing.
  6. Dimensions shown in parentheses are in millimeters.
  7. **FOR IRRIGATION PURPOSES ONLY.**

REV.	DATE	DESCRIPTION	BY	CKD. BY	WEIGHT POUNDS	VOLUME CUBIC FEET	FIGURE NUMBER
							<b>5560QT, 5561QT</b>

# PARTS LIST WITH MAINTENANCE INSTRUCTIONS

DRAWING NUMBER: S5560QTBS

SIZE: A

SCALE: NONE

DATE: 12-8-86

APPROVED BY: TD

CHECKED BY: VGD

DRAWN BY: WAS

F

WE CAN ASSUME NO RESPONSIBILITY FOR USE OF SUPERSEDED OR VOID DATA

DIMENSIONS ARE SUBJECT TO MANUFACTURERS TOLERANCE AND CHANGE WITHOUT NOTICE

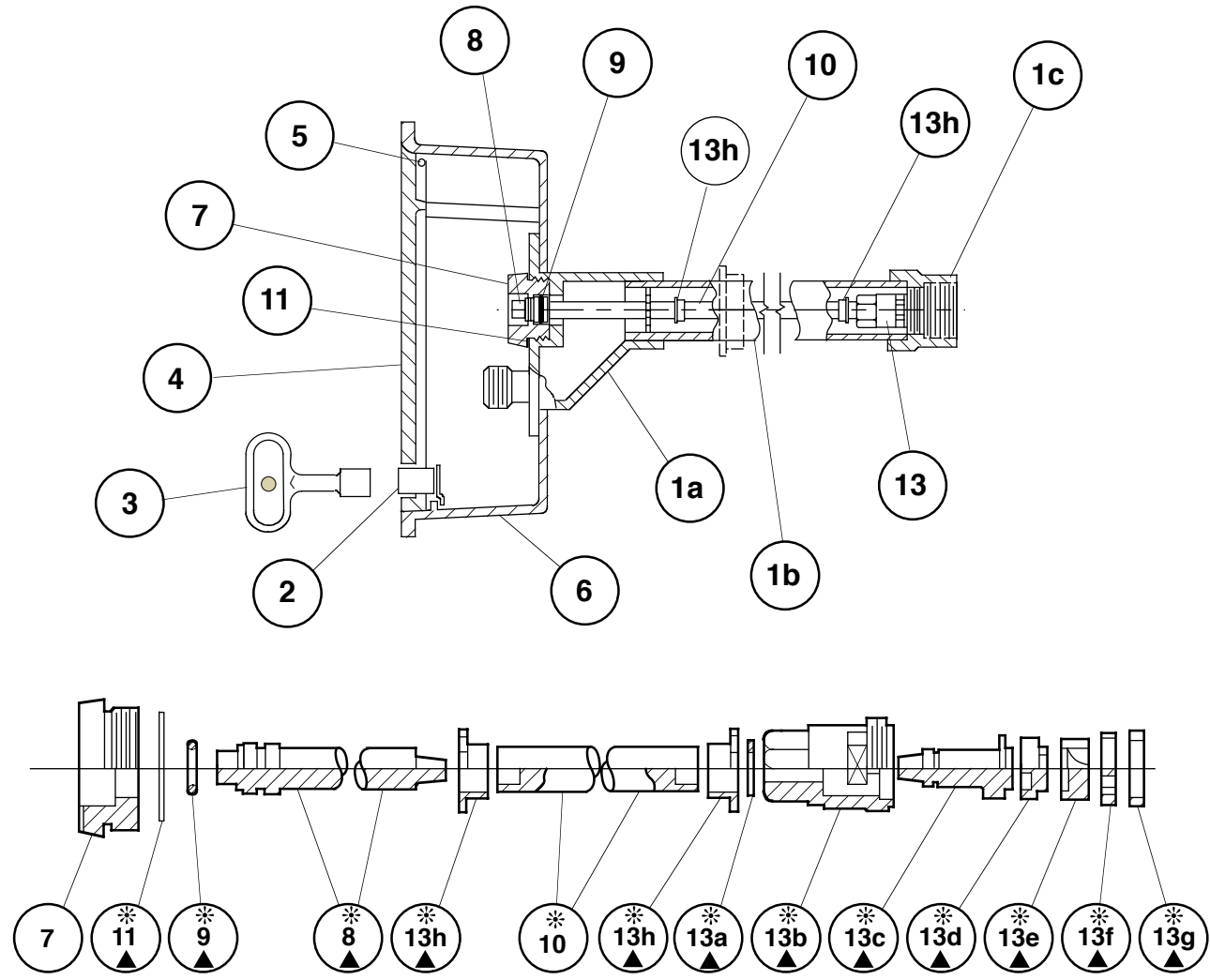

▲ These Replacement Parts Available in HPRK-7 (2) Repair Kits

\* These Parts Accessible from Face of Hydrant by Removing Face Nut.

HYDRANT PARTS LIST					
NO.	DESCRIPTION	NO.	DESCRIPTION	NO.	DESCRIPTION
1	Head/Casing Assembly	6	Box	13b	Valve Body
1a	Head	7	Face Nut	13c	Valve Actuator
1b	Casing	8	Actuator Shaft	13d	Nylon Thrust Washer
1c	Valve Housing	9	Actuator "O" Ring	13e	Rotating Ceramic Disc
2	Locking Device	10	Operator Rod	13f	Fixed Ceramic Disc
3	Key	11	Face Nut Washer	13g	Silicon Rubber Seal
4	Cover	13	Valve Body Assembly	13h	Retainer Guide (2)
5	Hinge Pins (2)	13a	Retaining Ring		

**Installer is responsible for providing a 100% watertight positive seal at the hydrant to box interface and hydrant to wall interface. Seal all interior joints, seams, gasket seams/closures including around the hydrant box flange with an appropriate sealant recommended by a sealant manufacturer. NOTE: Jay R. Smith does not warrant the performance or life expectancy of the sealant material.**

REV.	DATE	DESCRIPTION	BY	CKD. BY	WEIGHT POUNDS	VOLUME CUBIC FEET	<b>FIGURE NUMBER</b> <b>5560QT, 5561QTBS</b>
F	8-9-16	Added Note	TBW	BW			
E	9-22-93	Chg'd Note	EMB	BS			
D	9-17-92	Chg'd to QT Style	EMB	TD			
C	12-8-86	Revised	WAS				